

Actuator 20 Nm, Type 662R2111.

Technical Data



Actuator 20 Nm

Usage	for driving dampers and valves on combustion equipment	Dimensions [mm]	see dimension drawing
Power supply voltage	230 VAC/50 Hz	Screwed cable glands	2x M20x1,5, cabel Ø min. 8,0 mm, max. 13,0 mm
Form of shaft	Ø12 x 30, Form C02	Weigth [kg]	1,7
Running time [90°]	60 sec.	Protection class	IP54 with plastic cover
Controlling	DPS	Adaption	3x M6, screw-hole circle Ø 50 mm
End switches	2	Ambient temperature	-10...+ 60 °C
Additional switches	1	TÜV approval	when used with VMS/FMS/ETAMATIC

Illustrations and technical data refer to the standard version

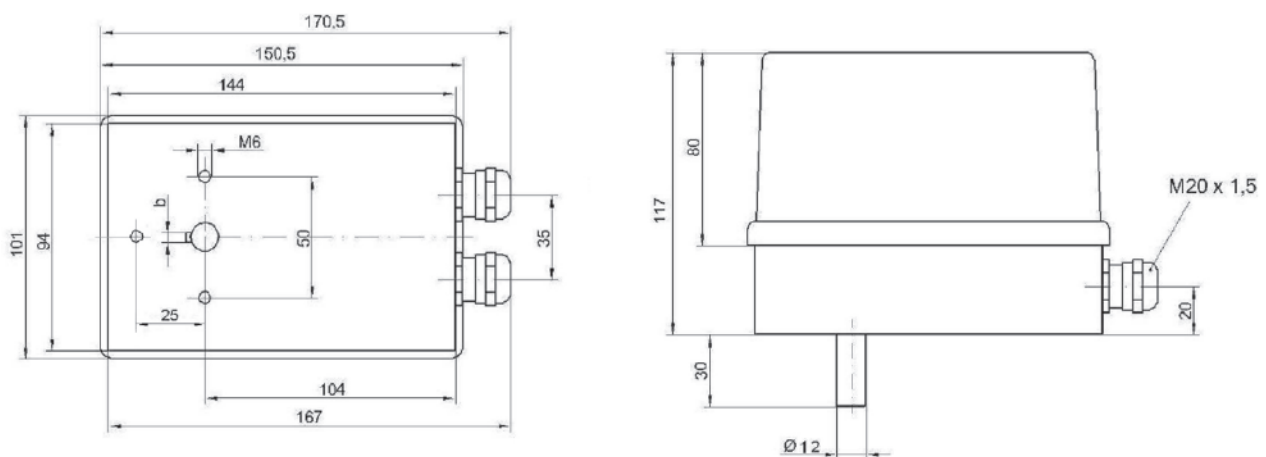

Dimension drawing Actuator 20 Nm Type 662R2111 IP54 with plastic cover (with metal cover H=84 mm)

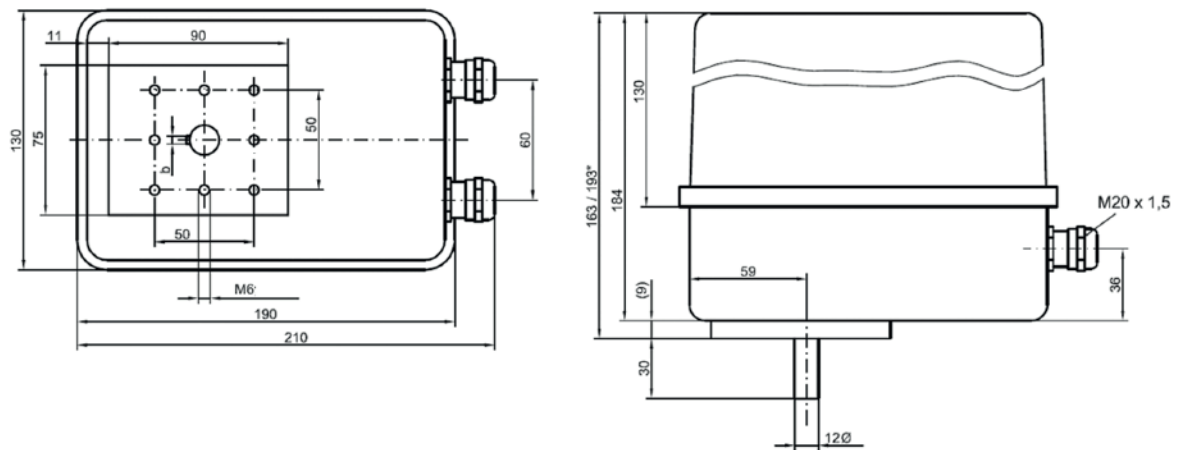

Dimension drawing Actuator 20-50 Nm Typ 662R2111/12/22 IP65 (*the height is depend on equipment)

Ordering Information

662 R 2111-	A 05 FORM OF SHAFT	A 10 POWER SUPPLY VOLTAGE	A 15 RUNNING TIME TO 90°	A 20 ANGULAR DISPLACE- MENT	A 25 CONTROLLING	A 30 POSITION FEEDBACK	A 35 ADDITIONAL POSITION FEEDBACK	A 40 ELECTRICAL MANUAL OVERDRIVE
A 45 IP PROTECTION CLASS	A 50 END- SWITCHES	A 55 ADDITIONAL SWITCHES	A 60 DIRECTION OF ROTATION	A 65 GEAR	A 70 ADAPTION	A 75 COLOUR	A 80 CABLE GLANDS	A 85 SPECIAL CONFIGURATION

Description / Type (standard variant)	Order no.
Actuator 20 Nm, 230 VAC, running time 60 sec. to 90°, TPS, position feedback POTENTIOMETER 5 kOHM, conductive plastic, TÜV approved, 2 end switches, 1 additional switch, without electr. override, IP54 1)	662 R 2111 - ...

1) Coupling or lever must be ordered separately

A 05 - FORM OF SHAFT	Selection
ROUND SHAFT 12x30 mm WITH PARALLEL KEY 4 x 4 x 14 mm	CO2*
SHAFT SPECIFICATION BY CUSTOMER	E01

A 10 - POWER SUPPLY VOLTAGE	Selection
POWER SUPPLY VOLTAGE 115 VAC/50 Hz	1155
POWER SUPPLY VOLTAGE 115 VAC/60 Hz	1156
POWER SUPPLY VOLTAGE 230 VAC/50 Hz	2305*
POWER SUPPLY VOLTAGE 230 VAC/60 Hz	2306
POWER SUPPLY VOLTAGE 24 VAC	24AC

A 15 - RUNNING TIME TO 90°	Selection
60 SECONDS	60*
RUNNING TIME SPECIFICATION BY CUSTOMER	—

A 20 - ANGULAR DISPLACEMENT	Selection
DISPLACEMENT 90°	090*
DISPLACEMENT 120°	120
DISPLACEMENT 135°	135
DISPLACEMENT 180°	180
DISPLACEMENT 270°	270

A 25 - CONTROLLING	Selection
THREE-POINT-STEP POSITION FEEDBACK „POTENTIOMETER USE“	DPS*
ELECTRONIC CONTROLLING 4...20 mA (only possible with CLASS OF PROTECTION IP65) POSITION FEEDBACK „4...20 mA“, additional position feedback “POTENTIOMETER 5 kOHM (COND. PLASTIC), TÜV approved”	REG

* (Default settings)

Ordering Information

A 30 – POSITION FEEDBACK		Selection
POTENTIOMETER 100 OHM (WIRE-WOUND)	only possible with THREE-POINT-STEP-CONTROLLING	100R
POTENTIOMETER 1 KOHM (WIRE-WOUND)	only possible with THREE-POINT-STEP-CONTROLLING	1K
POTENTIOMETER 200 OHM (WIRE-WOUND)	only possible with THREE-POINT-STEP-CONTROLLING	200R
POTENTIOMETER 5 KOHM (CONDUCTIVE PLASTIC), TÜV approved, POSITIVE, FREE OF BACKLASH, only possible with THREE-POINT-STEP-CONTROLLING		5K*
4...20 mA	Standard at ELECTRONIC CONTROLLING 4...20 mA	REG
Caution: position feedback at ETAMATIC/FMS/VMS not failsafe, use additional position feedback “POTENTIOMETER 5 KOHM (COND. PLASTIC), TÜV approved” !		
A 35 – ADDITIONAL POSITION FEEDBACK		Selection
WITHOUT ADDITIONAL POSITION FEEDBACK		0*
POTENTIOMETER 100 OHM (WIRE-WOUND)		100R
POTENTIOMETER 1 KOHM (WIRE-WOUND)		1K
POTENTIOMETER 200 OHM (WIRE-WOUND)		200R
POTENTIOMETER 5 KOHM (CONDUCTIVE PLASTIC), TÜV approved Mandatory for failsafe position feedback indication when using electronic control such as FMS/VMS/ETAMATIC		5K
A 40 – ELECTRICAL OVERRIDE		
selection not possible, delivery only with ELECTRICAL OVERRIDE		
A 45 – IP PROTECTION CLASS		Selection
IP54 WITH PLASTIC COVER		54*
IP54 WITH METAL COVER		54M
IP65 WITH METAL COVER		65
A 50 – END SWITCHES		Selection
2 END SWITCHES		ES2*
2 END SWITCHES GASTIGHT		ESG
A 55 – ADDITIONAL SWITCHES		Selection
WITHOUT ADDITIONAL SWITCHES		ZS0
1 ADDITIONAL SWITCH		ZS1*
2 ADDITIONAL SWITCHES		ZS2
3 ADDITIONAL SWITCHES		ZS3
4 ADDITIONAL SWITCHES		ZS4
1 ADDITIONAL SWITCH GASTIGHT		ZG1
2 ADDITIONAL SWITCHES GASTIGHT		ZG2
3 ADDITIONAL SWITCHES GASTIGHT		ZG3
4 ADDITIONAL SWITCHES GASTIGHT		ZG4

* (Default settings)

Ordering Information

A 60 - DIRECTION OF ROTATION^{*)} (view to the shaft parallel key on 12.00 o'clock)	Selection
DIRECTION OF ROTATION TO THE RIGHT (12.00 o'clock to 3.00 o'clock , clockwise ^{*)}	1R*
DIRECTION OF ROTATION TO THE LEFT (12.00 o'clock to 9.00 o'clock , anti-clockwise ^{*)}	2L
A 65 - GEAR	Selection
STANDARD	S*
GEAR FOR INCREASED TEMPERATURE 80 °C (only possible with IP65 PROTECTION CLASS)	W
A 70 - ADAPTION	Selection
3x M6, HOLE CIRCLE Ø 50 mm	S*
BY TYPE	T / U / W
BY DRAWING	ZG
A 75 -COLOUR	Selection
COVER BLUE	1B*
COVER BLACK	2S
A 80 -CABLE GLANDS	Selection
2x M20	1S*
CABLE GLANDS SPECIFICATION BY CUSTOMER	2K
A 85 -SPECIAL CONFIGURATION	Selection
WITHOUT SPECIAL CONFIGURATION	S00*
HOUSING HEATING 230 VAC/15 W, incl. THERMOSTAT, down to -30 °C (only possible with CLASS OF PROTECTION IP65)	S02

^{*)} (Default settings)