

NON-MAGNETIC TOUCH LATCH



MC-20



- Easy to install and adjust.
- Push to latch/unlatch.
- Includes screws.

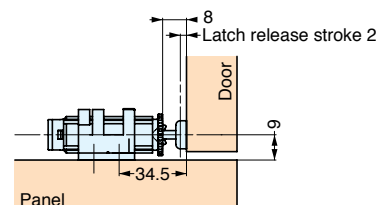
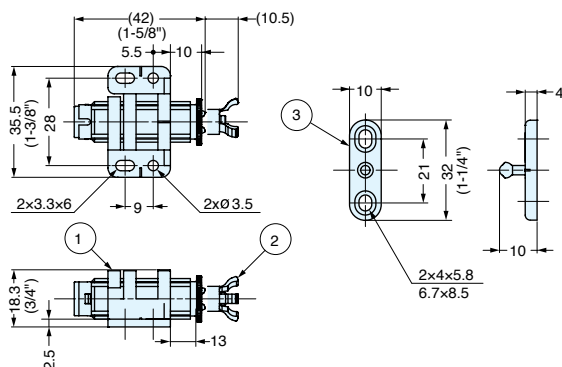

Item No.	Color	Retaining Force (kg)	Weight (g)	Box (pcs)	Carton (pcs)
MC-20BL	Black	4 (8.8 lbs)	6	30	600
MC-20WT	White				

No.	Part Name	Material	Finish/Color
①	Body	Polypropylene	Black (BL) White (WT)
②	Arm		
③	Strike		

NON-MAGNETIC TOUCH LATCH



MC-37



- Push to latch/unlatch.
- Strong retaining force.
- Floating strike allows for easy alignment.

Note:

- For overlay door, allow 3 mm (1/8") gap between door and cabinet frame for push space.
- Pulling the door with excessive force without unlatching the unit may damage the mechanism.
- Constant loading of over 4 kgf or excessive pushing or pulling is not recommended.

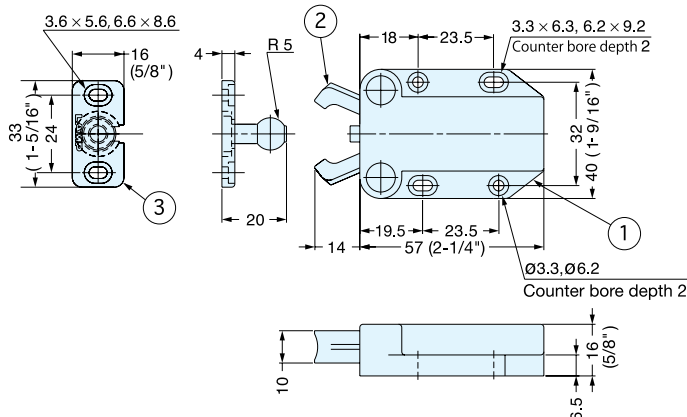
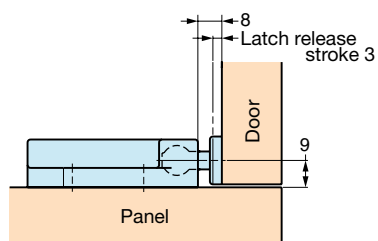

Item No.	Retaining Force (kg)	Weight (g)	Box (pcs)	Carton (pcs)
MC-37/BLK-1	8 (17.6 lbs)	24	30	300
MC-37/BRN-1				
MC-37/WHT-1				

No.	Part Name	Material	Finish/Color
①	Body	ABS	Black (BLK) Brown (BRN) White (WHT)
②	Arm	Polycetal	
③	Strike	Polyamide	