

Worm Gearmotor - catalogue A04

- Motor catalogue TX11 (Frequency 50 Hz)

#### Application given data

Required output speed	[min <sup>-1</sup> ]	28,0
Required input power	[kW]	1,50
Maximum ambient temperature	[°C]	40

**Designation:** MR IV 63 UO3A - 90L 4 ... B5 / 28 B3 i=50  
Mounting position B3,  $n_1 = 1400$  [min<sup>-1</sup>] , without motor (24 x 50 - 200)

Standard product : Yes

#### Accessories and special designs

#### Reducer/Gearmotor specifications

Transmission ratio i		2 x 25
Output speed $n_2$	[min <sup>-1</sup> ]	28,0
Input speed $n_1$	[min <sup>-1</sup> ]	1400
Input power $P_1$	[kW]	1,50
Output torque $M_2$	[N m]	387
Service factor $f_s$		0,71
Efficiency		0,76
Mass of gear reducer (without motor)	[kg]	17
Previsional lubricant quantity	[ l ]	1,0
ISO viscosity grade	[cSt]	320

#### Nominal Data

Nominal input power $P_{N1}$	[kW]	1,04
Nominal output power $P_{N2}$	[kW]	0,79
Nominal output torque $M_{N2}$	[N m]	270
Maximum output torque $M_{2max}$	[N m]	474

#### Verifications

Safety factor on $M_{2peak}$	N.A.
Thermal power verification	N.A.
External loads verificaton	N.A.

Top view with M.P. B3



N.A: Not Applied

The results of calculations in this document have no validity in terms of warranty. Computing: a) are theoretical, b) are based on the assumptions for optimal working conditions specified on Rossi catalogues, c) they rely on the truthfulness of given input data for which the customer is the only responsible, d) any omitted data or not taken into account by the customer voids the entire report. All contents, and information in this document are sole property of Rossi S.p.A. It cannot be disclosed for purposes other than the scope for which it has been generated under the agreement between the Customer and an authorized Rossi representative. It cannot be reproduced (in whole or in part) without explicit written permission by Rossi S.p.A. legal representative, and in this case the intellectual property of the document remains solely of Rossi S.p.A.

Worm Gearmotor - catalogue A04

Main Dimensions [mm]

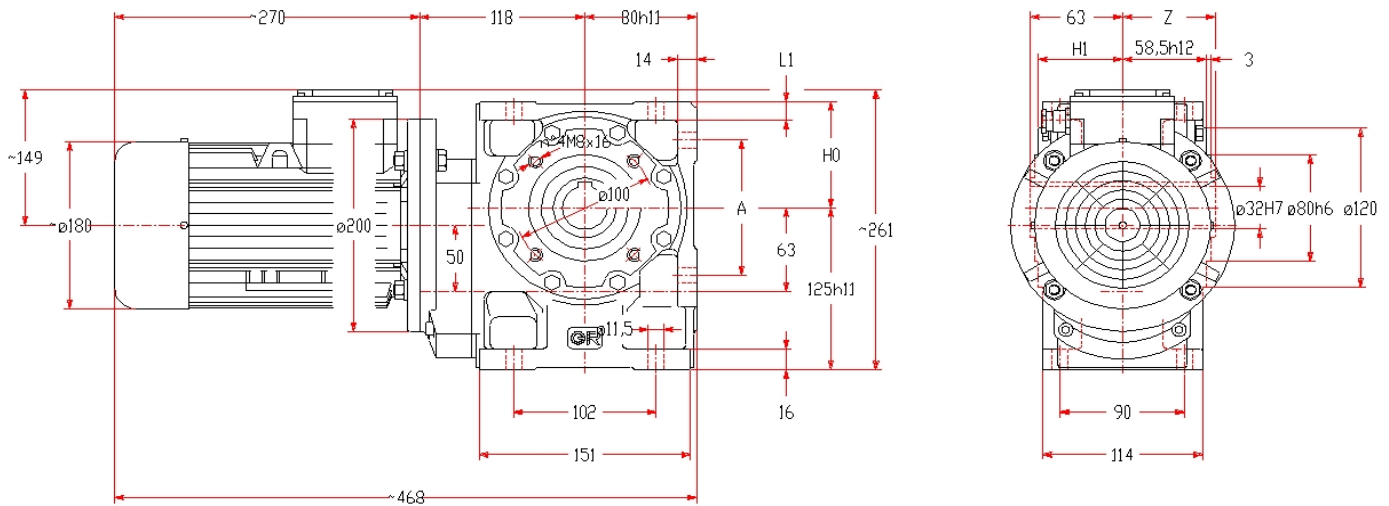

Informations and warnings:

Worm gear pair Z2/Z1 = 25/1; Axial module = 3,8; Helix angle = 7°21';

Static efficiency = 0,5; Statically reversible gear pair; Dynamic reversibility, after running-in, with efficiency > 0,6.

Fastening nuts: M10 UNI 5588. With screw UNI 5737, see pag. 81 Cat. A04 rev.11-06/2

Worm Gearmotor - catalogue A04

Design: UO3A

Mounting position: B3

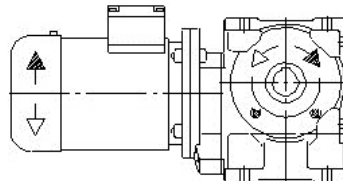
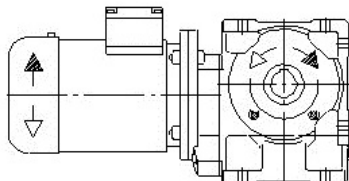

Plugs position

Standard hollow low speed shaft

Senza tappo di livello  
Fornito completo di olio

Without oil level plug  
Supplied filled with oil

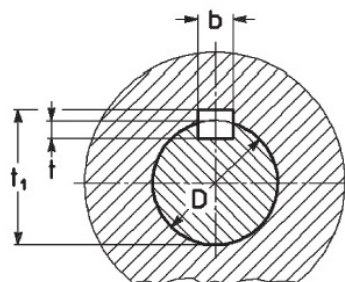

D	b x h x l	b	t	t <sub>1</sub>
ø32 H7	10 x 8 x 70	10	5	35,3

▼ = filler plug (in view/not in view)  
● = level plug (in view/not in view)  
■ = filler plug (in view/not in view)

The 3D drawing of following page, is in PDF format as it is meant only to show the overall design of the Gear reducer/Gearmotor. The 3D drawing consistent with the chosen configuration (position of plugs, type of low speed shaft, fixing holes, terminal box position, ...) can be downloaded from the "Selector", clicking the "Drawing CAD" button.

The results of calculations in this document have no validity in terms of warranty. Computing: a) are theoretical, b) are based on the assumptions for optimal working conditions specified on Rossi catalogues, c) they rely on the truthfulness of given input data for which the customer is the only responsible, d) any omitted data or not taken into account by the customer voids the entire report. All contents, and information in this document are sole property of Rossi S.p.A. It cannot be disclosed for purposes other than the scope for which it has been generated under the agreement between the Customer and an authorized Rossi representative. It cannot be reproduced (in whole or in part) without explicit written permission by Rossi S.p.A. legal representative, and in this case the intellectual property of the document remains solely of Rossi S.p.A.

Rossi S.p.A.  
Via Emilia Ovest 915/A - Modena - Italy  
Tel. 059 330288 - Fax 059 827774  
[info@rossi-group.com](mailto:info@rossi-group.com) - [www.rossi-group.com](http://www.rossi-group.com)