

Model MB-MX HIGH LOCK BASE

Mechanical lock & fine movement adjuster

Tightening torque + clamp force + fine adjustment function, all improved!



Free style by dial adjustment



Dial gage is optional



Holding Power
600N

MB-MX13F

Holding Power
800N

MB-MX20F

Holding Power
1000N

MB-MX28F

Holding Power
1000N

MB-MX40F

Consistent and highly accurate measurement

[Application]

While these bases are used as measuring tool holders, like magnetic bases, they can also be used to hold sensors in place.

[Features]

- Any position can be set by tightening a knob to lock every part.
- The clamp system is adjustable steplessly. Light turn achieves it.
- **Quick lock mechanism.**
- A wide variety of models, small to large, are available to suit your applications.
- The dial gage mounting part can be adjusted finely.
- The arm can be adjusted freely in angle and direction and provides stable, shake free positioning.

Optional upper fixture for sale!
(See page 58)

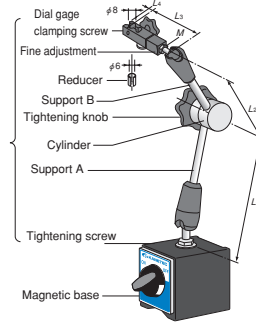
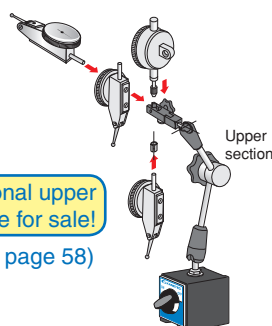

⟨Dial gage mounting⟩ ⟨Component names/Dimensions⟩ [mm (in)]

Model	Lock Mechanism	Holding Power	Magnetic Base			Arm					Tapped Hole	Indicator Clamp		Mass	Features
			Width	Length	Height	L ₁	L ₂	L ₃	L ₄	M		Stem Hole	Dovetail		
MB-MX13F	Mechanical Type	600N (60kgf)	40 (1.57)	40 (1.57)	40 (1.57)	57 (2.24)	46.5 (1.83)	61.5 (2.42)		M6(0.23) × 7 (0.28)	M6(0.23) × 1 (0.03)	φ 8 (0.31)	6.5 (0.25)	0.8kg/1.7 lb	Smallest type
MB-MX20F		800N (80kgf)		58 (2.28)		95 (3.74)	71 (2.79)		6.5 (0.25)	M6(0.23) × 10 (0.39)	M8(0.31) × 1.25 (0.04)	φ 6 (0.23) (When reducer is used)		1.4kg/3.1 lb	Small type
MB-MX28F		1000N (100kgf)	50 (1.96)		55 (2.16)	137 (5.39)	109.5 (4.31)	63.5 (2.50)						2.1kg/4.6 lb	Standard type
MB-MX40F				73 (2.87)		197 (7.75)	170 (6.69)			M6(0.23) × 12 (0.47)				2.2kg/4.8 lb	Long arm type

※ The holding power applies to SS400, thickness 10 mm and ground surface.

Model MB-X HIGH LOCK MINI BASE

Mechanical lock type

Dial gage is optional

Small and simple, suitable for use in limited space.

[Application]

While these bases are used as measuring tool holders like magnetic bases, they can also be used to hold sensors in place.

[Features]

- A mechanical lock system that tightens joints in three places by one operation.
- The arm can be adjusted freely, which facilitates locating the mounted measuring instrument.

[mm (in)]

Model	Lock Mechanism	Holding Power	Magnetic Base			Arm			Tapped Hole	Indicator Clamp		Mass	Features
			Width	Length	Height	L ₁	L ₂	L ₃		Stem Hole	Dovetail		
MB-CX	Mechanical Type	160N (16kgf)	28 (1.10)	28 (1.10)	29 (1.14)	46 (1.81)	46 (1.81)	39 (1.53)	M5(0.19) × 0.8 (0.03)	φ 6 (0.23) × 2	6.5 (0.25)	0.38kg/ 0.8 lb	Small, V attractive face
MB-PSX		300N (30kgf)	30 (1.18)	34 (1.33)	35 (1.37)								Small, magnet switchover

※ The holding power applies to SS400, thickness 10 mm and ground surface.